

SOLD

2/89 Kingsford Drive

2, 89 Kingsford Drive, Brunswick Heads



Downsize In Brunswick Heads

This small block is the only vacant lot available in the whole of Brunswick Heads. It's flat and fully serviced with approved plans to build a cute 2-bedroom house, perfect for the downsizer.

The lot is opposite Lilly Pilly preschool and playpark, close to the bowlo, sporting fields and skatepark. Just a 15-minute walk along Simpsons Creek into town where you can enjoy village life. With the iconic Brunswick Hotel, river, beaches, cafes and shops at your fingertips, life will be sweet!

In the last 12 months, the average price for any home in this development is well over \$1,000,000 and the market is still trending upwards. This property is the cheapest way into the Brunswick Heads market. Don't hesitate.

Agent declares interest.

187 m2

Price	SOLD
Property Type	Residential
Property ID	1078
Land Area	187 m2

Agent Details

Todd Buckland - 0408
966 421

Office Details

Brunswick Heads
3 Fawcett St Brunswick
Heads, NSW, 2483
Australia
02 6685 1754

The above information provided has been furnished to us by the vendor/s. We have not verified whether or not that information is accurate and do not have any belief in one way or the other in its accuracy. We do not accept any responsibility to any person for its accuracy and do no more than pass it on. All interested parties should make and rely upon their own inquiries in order to determine whether or not this information is in fact accurate.

89A Kingsford Drive
Brunswick Heads NSW

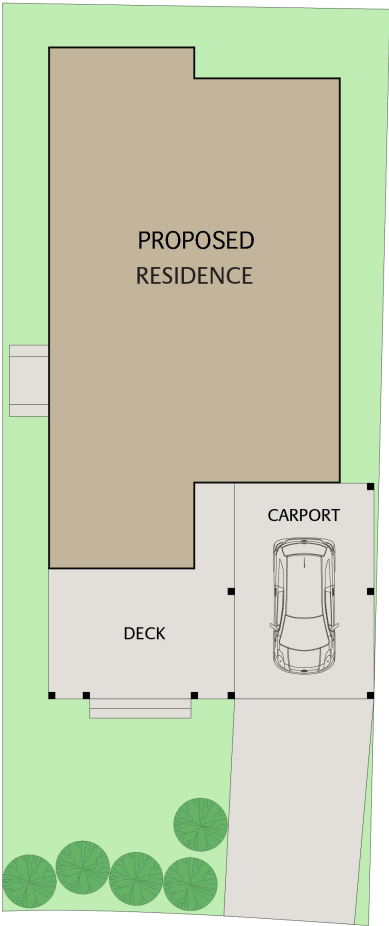

KINGSFORD DRIVE

NOTE: Every precaution has been taken to verify the accuracy of the above details. However, prospective purchasers are advised to make their own enquiries.

