

SOLD



16 Green Frog Lane, Bangalow



## A Charmed Life

### Village Classic

It's hard not to be charmed by this c1920's weatherboard. With restoration at the heart of its' recent revival, the owner has preserved every period feature of the house and the results will bring a smile.

The location is both quiet and convenient with very little passing traffic at the end of this family friendly cul de sac just a few minutes walk from the village.

A quaint and well planned landscaped garden befitting the home with heritage fragrant roses, magnolias and jasmine surrounds the home. The big backyard is complete with "she shed", garden locker and quirky potting shed and is bathed in winter sun.

An ideal village home.

🏠 3 🌿 2 🚗 2 📏 710m2

**Price** SOLD for  
\$942,500

**Property Type** Residential

**Property ID** 734

**Land Area** 710 m2

### Agent Details

Todd Buckland - 0408  
966 421

### Office Details

Brunswick Heads  
3 Fawcett St Brunswick  
Heads, NSW, 2483  
Australia  
02 6685 1754

C1926 Queenslander with 11 ft ceilings  
 Granite kitchen benchtops & claw foot bath  
 Original lining boards & polished timber floors  
 New stumps, wiring & plumbing  
 Verandas front & back  
 Many collectable fixtures, fittings and inclusions

*The above information provided has been furnished to us by the vendor/s. We have not verified whether or not that information is accurate and do not have any belief in one way or the other in its accuracy. We do not accept any responsibility to any person for its accuracy and do no more than pass it on. All interested parties should make and rely upon their own inquiries in order to determine whether or not this information is in fact accurate.*

**BYRON SHIRE**  
 REAL ESTATE



FLOOR PLAN

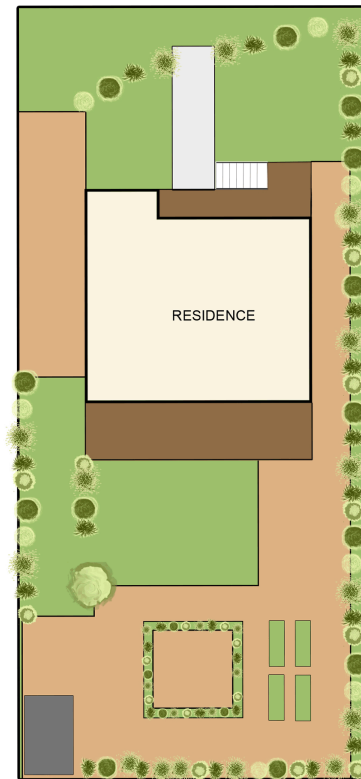

SITE PLAN

## 16 Greenfrog Lane Bangalow

This floor plan including furniture, fixture measurements and dimensions are approximate and for illustrative purposes only. Raffpics.com.au gives no guarantee, warranty or representation as to the accuracy and layout. All enquiries must be directed to the agent, vendor or party representing this floor plan.